

**Product data sheet**  
**Single lever washbasin mixer tap AQ1.12M10640**

# HEWI

Available in DE, AT, FR, BE, PL, NL, LU

**Single lever washbasin mixer tap AQ1.12M10640**

- high-quality chrome-plated, round tube
- with coloured lever grip element made of polyamide in selected HEWI colours
- flow rate 5 l/min
- Kerox K-35B ceramic cartridge, pressure resistant up to 35 bar
- laminar flow regulator with dynamic flow control 5 l/min, with anti-theft protection
- connection via flexible pressure hoses with woven-in hot-cold marking, 450 mm long, G 3/8
- brass fitting body
- open operating lever with hot-cold marking
- 270 mm high, 187 mm projection
- swivel spout, can be optionally locked in position
- without waste fittings
- noise class 1
- suitable for thermal disinfection to DVGW W 551
- DVGW certified
- with WELL label



Dimensions in mm

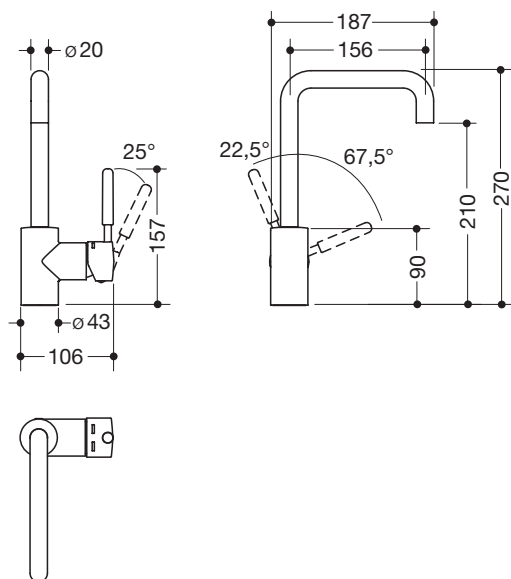

Surface fitting

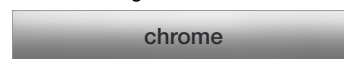

Colours

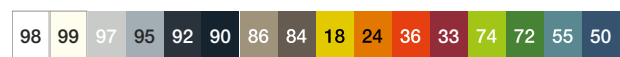

Gripping element

Technical information subject to alteration, 16th August 2019

HEWI Heinrich Wilke GmbH  
 Postfach 1260  
 D-34442 Bad Arolsen

Telefon: +49 5691 82-366  
 Telefax: +49 5691 82-99366  
 international@hewi.com  
 www.hewi.com

HEWI (UK) Limited  
 Holm Oak Barn, Beluncle Halt  
 Stoke Road  
 Hoo Kent ME3 9NT

Phone +44 1634 258 200  
 Fax +44 1634 250 099  
 info@hewi.co.uk  
 www.hewi.com