

Product data sheet
Backrest 900.51.90660

HEWI

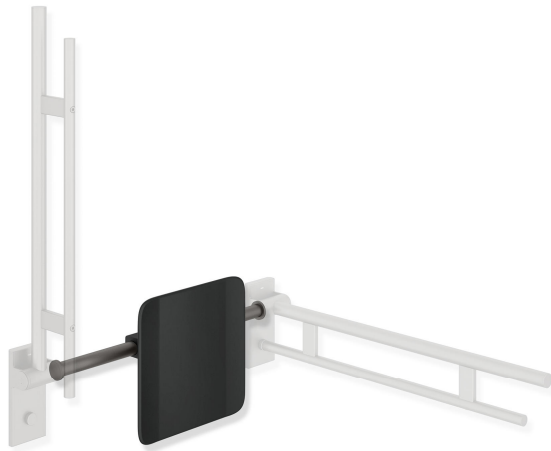

Backrest 900.51.90660

- backrest with fixing rails on both sides
- serves as back support for toilet users
- mounting onto hinged support rails, design (A) from the System 900
- 330 mm high and 150 mm deep, backrest 350 mm wide, rail diameter 32 mm, tube thickness 2 mm
- centre-to-centre from 486 to 586 mm (clear dimension between the rails of the hinged support rails 548-648 mm) adjustable on site
- connection made of high-quality stainless steel, powder-coated in the HEWI colour CV (matt black) and ER (matt dark grey pearl mica) with a black backrest or powder-coated in the HEWI colours AS (matt white) and AX (matt dark grey pearl mica) with a white backrest
- including non-corrosive and tested HEWI fixing material
- fulfils the requirements to British-Standard BS 8300:2009+A1:2010/Doc M.

Similar picture



Dimensions in mm

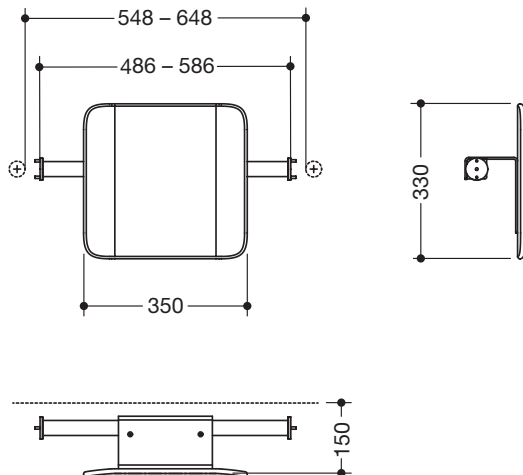

Surfaces/Colours



The colour CD will be discontinued 31.03.2022

Alternative surfaces/colours



Technical information subject to alteration, 29th March 2021

HEWI Heinrich Wilke GmbH
Postfach 1260
D-34442 Bad Arolsen

Telefon: +49 5691 82-366
Telefax: +49 5691 82-99366
international@hewi.com
www.hewi.com

HEWI (UK) Limited
Holm Oak Barn, Beluncle Halt
Stoke Road
Hoo Kent ME3 9NT

Phone +44 1634 258 200
Fax +44 1634 250 099
info@hewi.co.uk
www.hewi.com