

Product data sheet
Backrest 801.51.9263R

HEWI



Similar picture

Backrest 801.51.9263R

- back rest with right-angled rods and fixing rosettes attached on both sides
- serves to support the back on the WC
- right-hand version
- mounted on one side on the wall with rosettes (left)
- mounted on one side on hinged support handles or wall support handles with wall plate (right)
- adjustable on site
- 650 to 750 mm wide, 150 mm deep, back rest 334 mm high and 370 mm wide, rod diameter 33 mm, rosette diameter 70 mm
- with continuous, corrosion-protected steel core
- back rest made of synthetic material in HEWI colour 90 (jet black)
- connection made of high-gloss polyamide according to HEWI colour chart
- meets the requirements according to DIN 18040 and ÖNORM B1600/1601

Dimensions in mm

Available from 1st February 2021

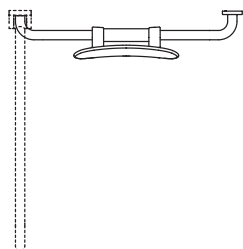
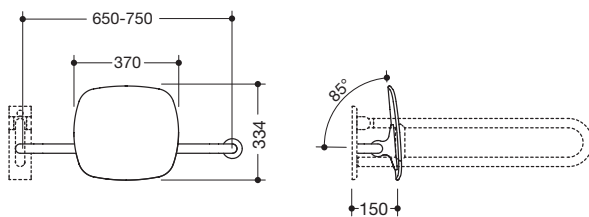

Colours

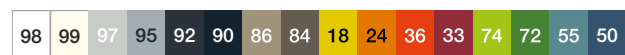

Connection



Backrest

Technical information subject to alteration, 27th November 2020

HEWI Heinrich Wilke GmbH
Postfach 1260
D-34442 Bad Arolsen

Telefon: +49 5691 82-366
Telefax: +49 5691 82-99366
international@hewi.com
www.hewi.com

HEWI (UK) Limited
Holm Oak Barn, Beluncle Halt
Stoke Road
Hoo Kent ME3 9NT

Phone +44 1634 258 200
Fax +44 1634 250 099
info@hewi.co.uk
www.hewi.com